

HF, HFD, HFDX FLUID COUPLINGS

Radially Displaceable HF / HFD / HF-DX

These couplings are radially displaceable, enabling prealignment of driving and driven shafts prior to assembly. A metallic flexible disc coupling is fitted to both ends. They give starting torque down to 120% of nominal torque. The HF is a standard coupling; HFD comes with a delayfil chamber and HF-DX with extended delayfil chamber. Standard fusible plug blow off temperature is 130 degrees C.

PERFORMANCE DATA

Part No. HF, HFD, HFDX	Max Bore	Max kW at input speed		Max speed *
		900	1470	
3	55.0	2	10	1800
4	60.0	4	15	1800
5	60.0	7	30	1800
6	75.0	9	40	1800
7	75.0	15	62	1800
8	80.0	18	80	1800
8B	90.0	29	125	1800
9	90.0	41	172	1800
9B	110.0	54	228	1800
10	110.0	73	275	1800
10B	110.0	107	373	1800
11	115.0	158	475	1470
12	145.0	278	750	1470
13	145.0	550	1100	1470
14	195.0	758	-	1200
15	195.0	1148	-	970

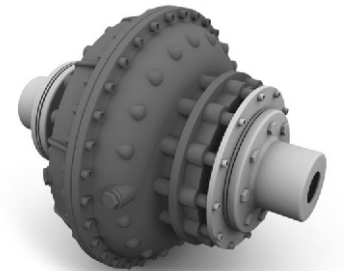

DIMENSIONAL DATA

Part No.	Max Bore	A	B			B1
			HF	HFD	HFDX	
3	55.0	342.0	239.0	295.0	329.0	70
4	60.0	367.0	264.0	320.0	354.0	70
5	60.0	406.0	285.0	315.0	375.0	70
6	75.0	435.0	332.0	358.0	429.0	95
7	75.0	471.0	345.0	390.0	460.0	95
8	80.0	505.0	366.0	407.0	487.0	95
8B	90.0	553.0	405.0	445.0	535.0	110
9	90.0	584.0	395.0	445.0	526.0	110
9B	110.0	620.0	446.0	511.0	589.0	125
10	110.0	644.0	468.0	517.0	611.0	125
10B	110.0	714.0	491.0	537.0	632.0	125
11	115.0	751.0	511.0	566.0	661.0	125
12	145.0	845.0	614.0	700.0	820.0	200
13	145.0	960.0	697.0	745.0	875.0	200
14	195.0	1104.0	770.0	813.0	943.0	200
15	195.0	1230.0	-	901.0	1031.0	200

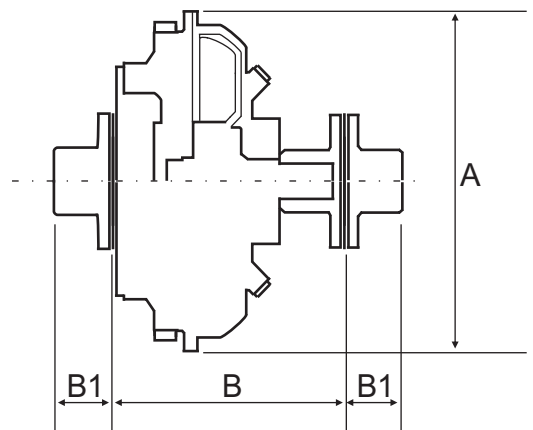

* Higher speeds available on request