

SM, SMD, SMDX FLUID COUPLINGS

Shaft Mounted SM / SMD / SM - DX

The shaft mounted fluid couplings are axially compact with elastomeric coupling on one end. They give starting torque down to 120% of nominal torque. The SM is a standard coupling; SMD comes with a delayfil chamber and SM-DX with extended delayfil chamber. Standard fusible plug blow off temperature is 130 degrees C.

PERFORMANCE DATA

Part No. SM, SMD, SMDX	Max Bore Fluid Coupling	Max Bore Flex side	Max Kw rating at input speed		Max * Speed
			900	1470	
3	42.0	60.0	2	10	1800
4	50.0	60.0	4	15	1800
5	65.0	75.0	7	30	1800
6	70.0	90.0	9	40	1800
7	80.0	90.0	15	62	1800
8	80.0	100.0	18	80	1800
8B	95.0	100.0	29	125	1800
9	95.0	100.0	41	172	1800
9B	95.0	125.0	54	228	1800
10	110.0	125.0	73	275	1800
10B	110.0	120.0	107	373	1800
11	120.0	120.0	158	475	1470
12	130.0	140.0	278	750	1470
13	150.0	160.0	550	1100	1470
14	160.0	160.0	758	-	1200
15	160.0	180.0	1148	-	970
16	190.0	180.0	1400	-	970
16DC	190.0	-	1862	-	970



DIMENSIONAL DATA

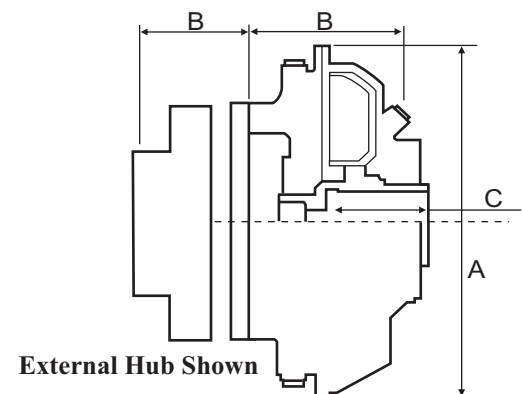

Part No. SM, SMD, SMDX	Max Bore Fluid Coupling	Max Bore Flex side	A	B			C	B1 Internal	B1 External	B1 Pad
				SM	SMD	SMDX				
3	42.0	60.0 - E	342.0	158.0	213.0	247.0	80.0	67.0	130.0	-
4	50.0	60.0 - E	367.0	160.0	215.0	249.0	90.0	67.0	130.0	-
5	65.0	75.0 - E	406.0	190.0	220.0	280.0	110.0	72.0	150.0	-
6	70.0	90.0 - E	435.0	213.0	239.0	310.0	120.0	72.0	170.0	-
7	80.0	90.0 - E	471.0	218.0	263.0	333.0	135.0	72.0	170.0	-
8	80.0	100.0 - E	505.0	238.0	279.0	359.0	140.0	87.0	195.0	-
8B	95.0	100.0 - E	553.0	250.0	290.0	380.0	155.0	87.0	195.0	-
9	95.0	100.0 - E	584.0	255.0	305.0	385.0	155.0	87.0	195.0	-
9B	95.0	125.0 - E	620.0	270.0	335.0	430.0	160.0	-	230.0	120.0
10	110.0	125.0 - E	644.0	280.0	329.0	424.0	170.0	-	230.0	120.0
10B	110.0	120.0 - P	714.0	310.0	355.0	451.0	190.0	-	-	151.0
11	120.0	120.0 - P	751.0	320.0	375.0	471.0	200.0	-	-	151.0
12	130.0	140.0 - P	845.0	359.0	435.0	555.0	240.0	-	-	167.0
13	150.0	160.0 - P	960.0	441.0	489.0	619.0	270.0	-	-	179.0
14	160.0	160.0 - P	1104.0	451.0	494.0	624.0	275.0	-	-	194.0
15	160.0	180.0 - P	1230.0	485.0	594.0	724.0	275.0	-	-	214.0
16	190.0	180.0 - P	1298.0	-	571.0	-	320.0	-	-	214.0
16DC	190.0	-	1298.0	-	830.0	-	320.0	-	-	-

* Higher speeds available on request