



PERFORMANCE DATA

JAW TYPE 'SWR' COUPLING

'SWR' TYPE

Spacer coupling for shaft to shaft connection. Ideally suited to pump applications, as the spacer can be removed radially, without disturbing driver or driven equipment.



Part No.	Max Bore	Power at 100 RPM kW	Nominal Torque (Nm)			Normal Maximum Speed (RPM)
			Rubber	Polyurethane		
			Black 80 Sh A	Yellow 80 Sh A	Red 90 Sh A	
SWR095	28.0	0.221	21.1	30.0	40.0	3000
SWR100	35.0	0.486	46.4	75.0	90.0	3000
SWR110	42.0	0.932	89.0	140.0	165.0	3000
SWR150	48.0	1.476	141.0	190.0	225.0	3000
SWR190	60.0	1.990	190.0	250.0	300.0	3000
SWR225	65.0	2.775	265.0	325.0	400.0	3000

Power at 100 RPM based on Rubber 80 Shore A (Black)

Complete SWR Coupling Consists of:
 2 - "N" type hubs
 1 - Spacer
 2 - Wrap around rubbers
 2 - Collars with screws

DIMENSIONAL DATA

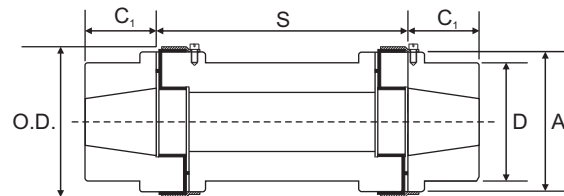
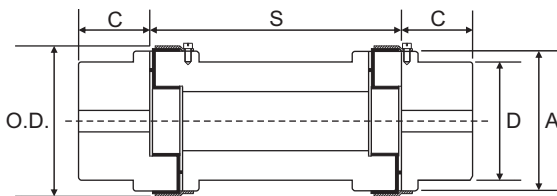

Part No.	Bore		Taper Bush Size	A	C	C ₁	D	Collar O.D.	S*
	Min	Max							
SWR095	10.0	28.0	-	54.0	25.0	-	49.0	64.0	100/140
SWR100	10.0	35.0	1108	65.0	35.0	23.6	57.0	78.0	100/140
SWR110	15.0	42.0	1210	85.0	43.0	27.2	76.0	96.0	100/140/180
SWR150	15.0	48.0	1210	96.0	45.0	27.2	80.0	111.0	100/140/180
SWR190	20.0	60.0	1610	115.0	54.0	27.6	102.0	130.0	100/140/180
SWR225	20.0	65.0	2012	127.0	64.0	33.5	111.0	142.0	100/140/180

*S = Spacer lengths